

Cut List for Two Cabinets

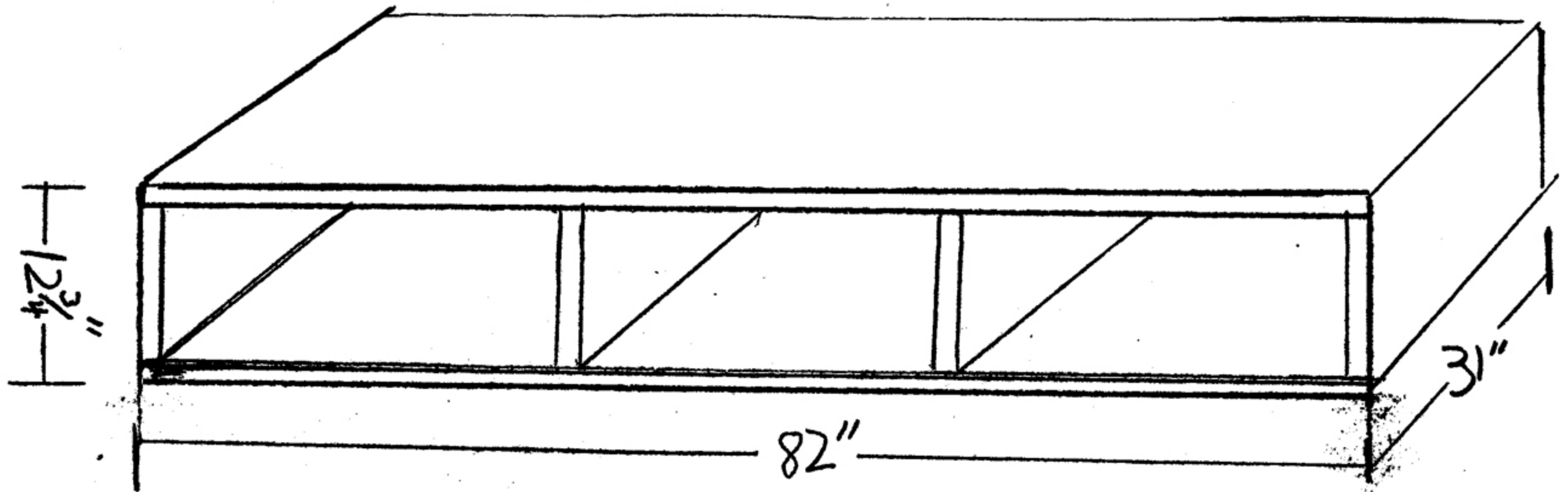

- 4) $82'' \times 30\frac{1}{4}'' \times \frac{3}{4}''$ Ply wood = Tops & Bottoms
4) $10\frac{1}{2}'' \times 30\frac{1}{4}'' \times \frac{3}{4}''$ Ply wood = Sides of cabinet
12) $10\frac{1}{2}'' \times 30'' \times \frac{3}{4}''$ Ply wood = Dividers

Face Frame & Cabinet Filler strips

- 2) $\frac{3}{4}'' \times 1'' \times 82''$ = Ply wood Filler strips / Nailers
10) $\frac{3}{4}'' \times 1\frac{1}{4}'' \times 30''$ = Drawer supports = So Drawers Don't tip forward
4) $1\frac{1}{2}'' \times \frac{3}{4}'' \times 82''$ = Poplar Face frame
8) $1\frac{1}{2}'' \times \frac{3}{4}'' \times 9\frac{3}{4}''$ = Poplar Face frame
2) $\frac{1}{4}'' \times 10\frac{1}{2}'' \times 80\frac{1}{2}''$ = Backs

Ply wood Break Down for Cabinets

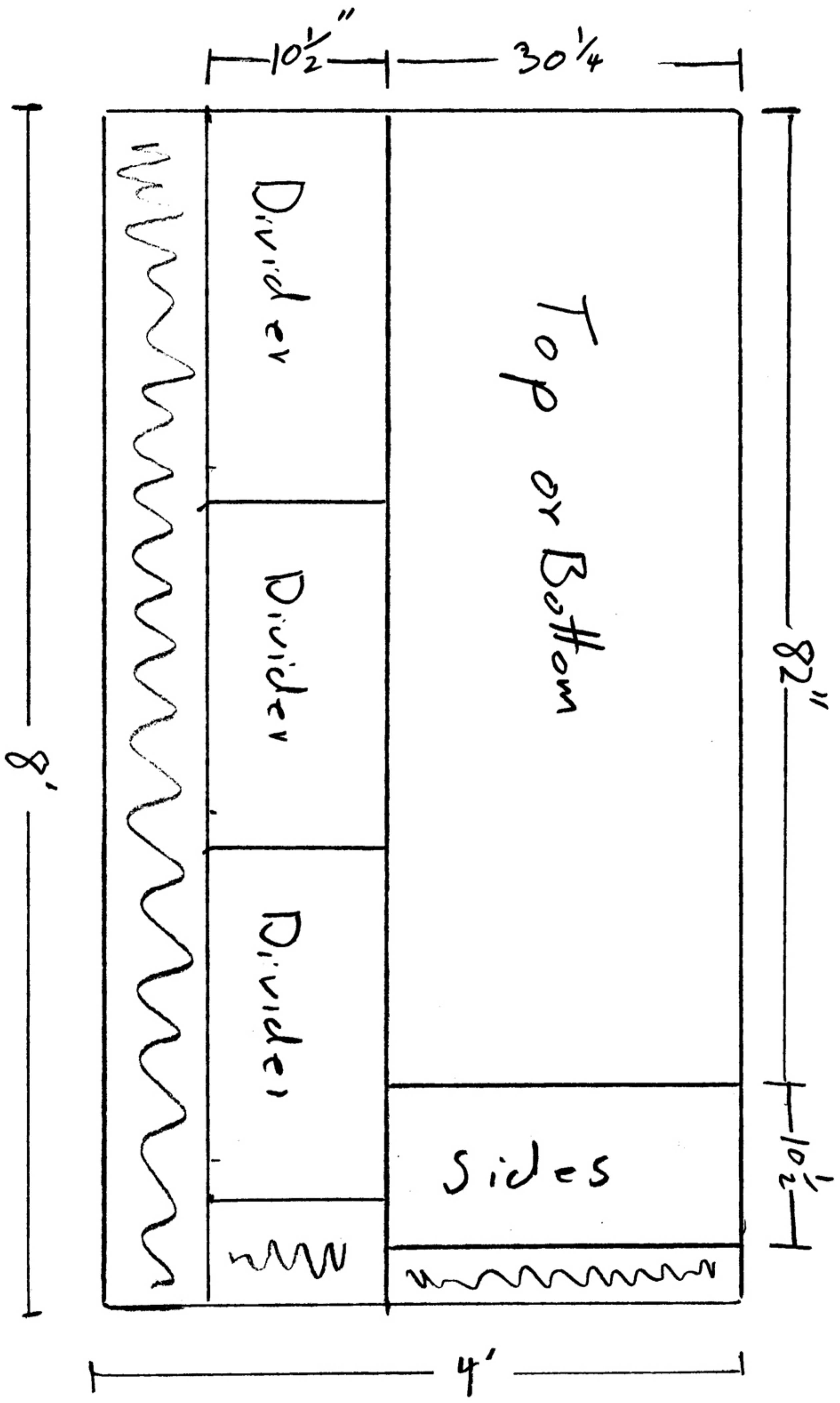

From one Sheet = 1) Top or Bottom

- 1) Side
- 3) Dividers

The Base

- 2) 3" x 82" x 3/4 Poplar
- 6) 3" x 56" x 3/4 Ply wood
- 2) 3" x 82" x 1/4 walnut

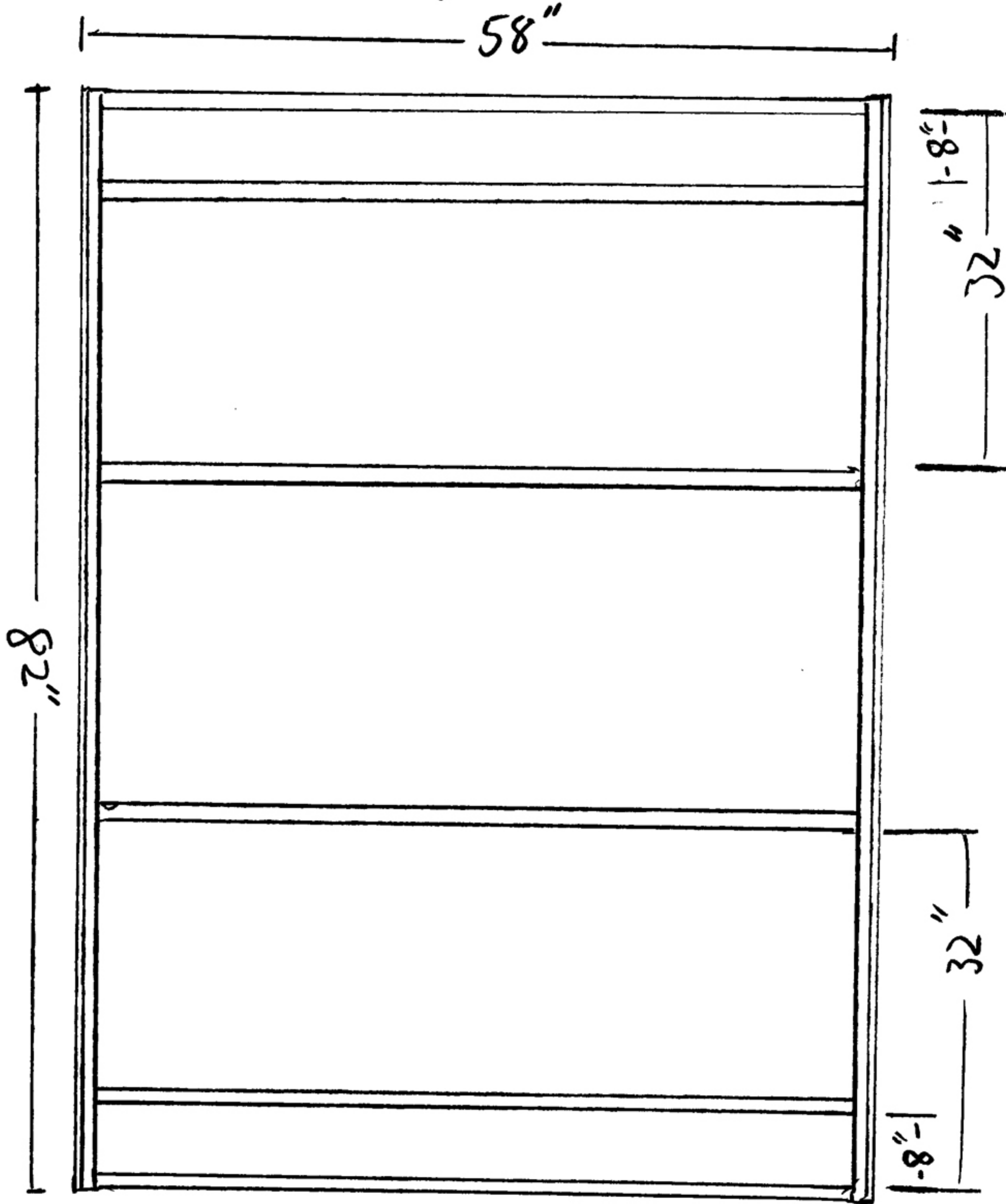

Drawers

12) Sides $9\frac{5}{8} \times 30 \times \frac{3}{4}$

6) Fronts $9\frac{5}{8} \times 23\frac{11}{16} \times \frac{3}{4}$

6) Backs $9\frac{1}{8} \times 24\frac{3}{16} \times \frac{3}{4}$

6) $\frac{1}{4}$ " Drawer Bottoms $24\frac{11}{16} \times 29\frac{1}{2}$
Cut to fit! ↗

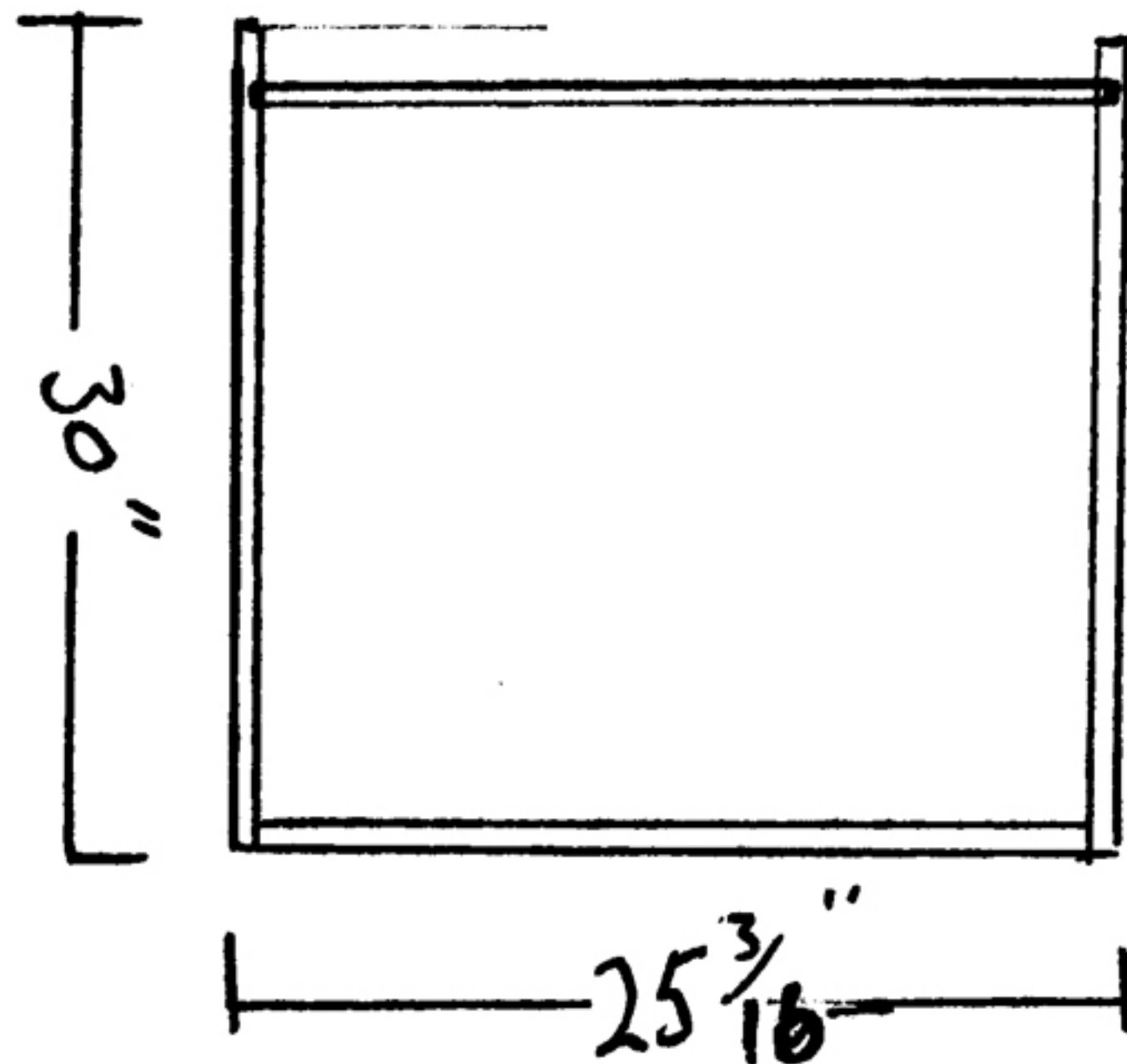

Drawer Fronts

2) $25\frac{3}{4} \times 10\frac{3}{4} \times \frac{3}{4}$ = The Two Center Drawers

4) $26 \times 10\frac{3}{4} \times \frac{3}{4}$ = Drawers at the ends of Cabinet

Head Board

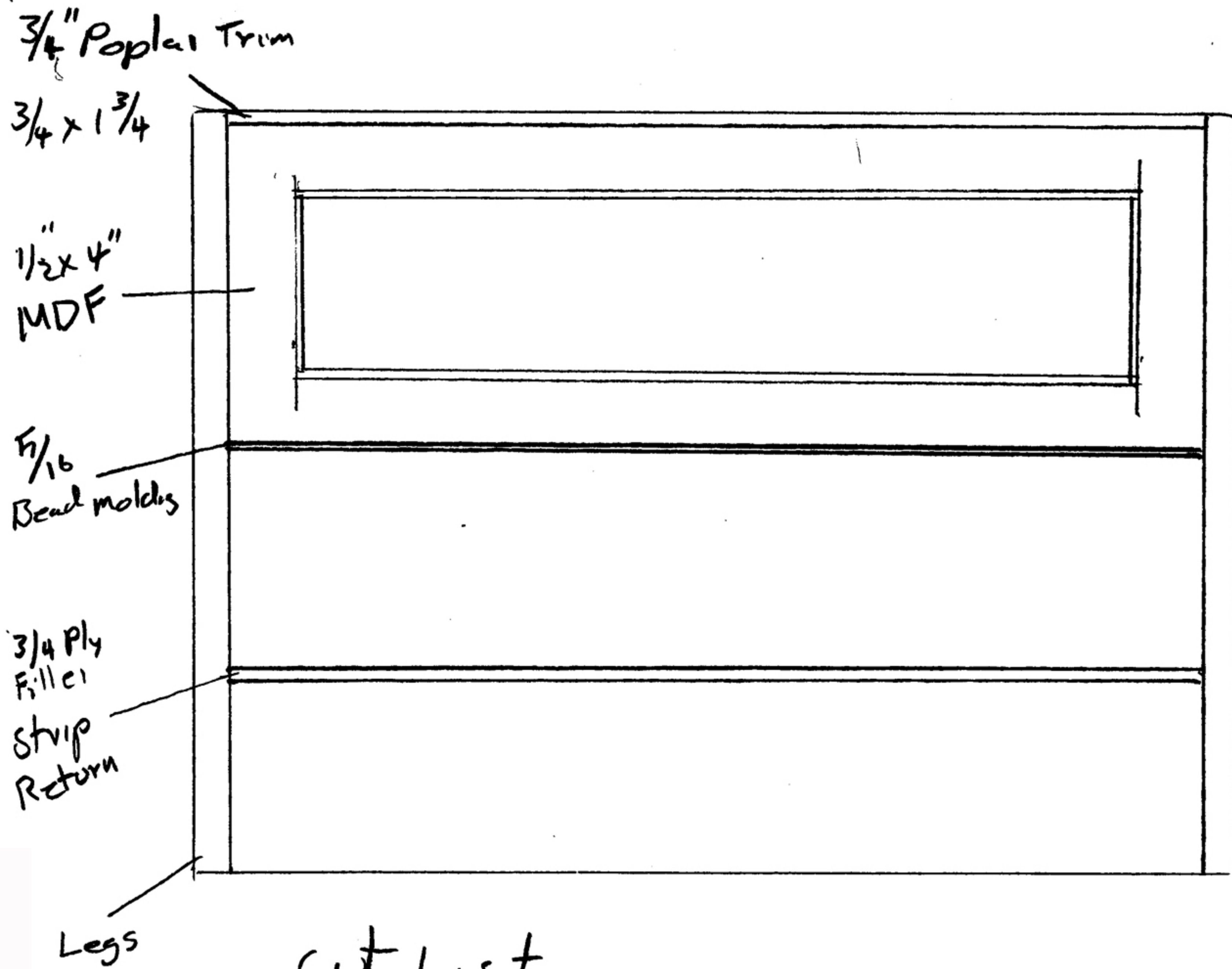

cut List

2) $1\frac{3}{4} \times 2\frac{3}{4} \times 47\frac{1}{2}$ = Legs

1) $\frac{3}{4}$ " Ply wood $\times 31\frac{3}{4} \times 58\frac{1}{4}$

$58\frac{1}{4} \times 31\frac{3}{4} \rightarrow$

1) $\frac{3}{4} \times 1\frac{3}{4}$ " Plywood $\times 58\frac{1}{4}$ Filler strip

1) $\frac{3}{4}$ " Plywood $14\frac{1}{4} \times 58\frac{1}{4}$

$58\frac{1}{4} \times 1\frac{3}{4} \rightarrow$

2) $\frac{1}{2} \times 4$ " $\times 58\frac{1}{4}$ MDF

2) $\frac{1}{2} \times 4$ " $\times 12\frac{1}{2}$ MDF

$58\frac{1}{4} \times 14\frac{1}{4} \rightarrow$

1) $\frac{3}{4} \times 1\frac{3}{4} \times 58\frac{1}{4}$ Poplar Trim for Top

Side View of Ply wood

Foot Board

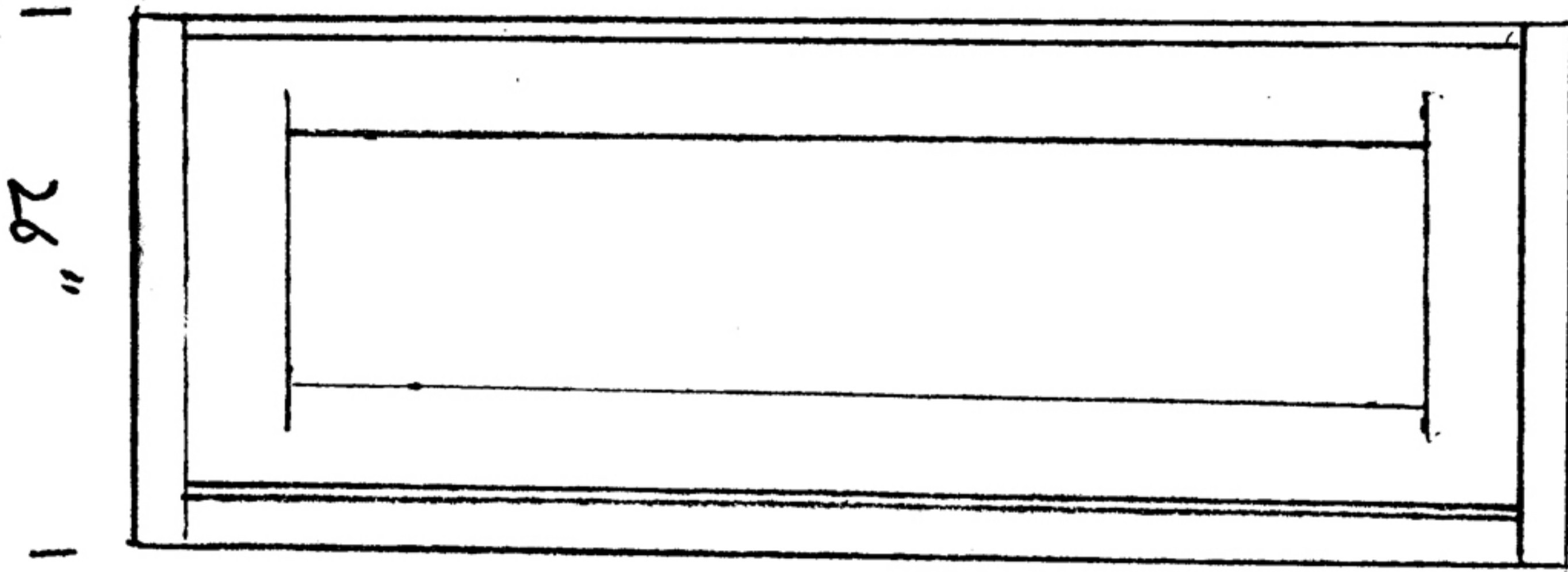

2) $1\frac{3}{4} \times 2\frac{3}{4} \times 26'' =$ Legs

1) $\frac{3}{4}$ Ply wood $25\frac{1}{4} \times 58\frac{1}{4}$

2) $\frac{1}{2} \times 4 \times 58\frac{1}{4}$ MDF

2) $\frac{1}{2} \times 4 \times 15\frac{1}{4}$ MDF

1) $\frac{3}{4} \times 1\frac{3}{4} \times 58\frac{1}{4}$ Poplar Trim for Top

walnut molding

1) $\frac{1}{16} \times 2\frac{1}{4} \times 58\frac{1}{4} =$ molding at Bottom of Foot Board

2) $\frac{1}{4} \times \frac{3}{4} \times 82''$
molding at Top
of Bed cabinets

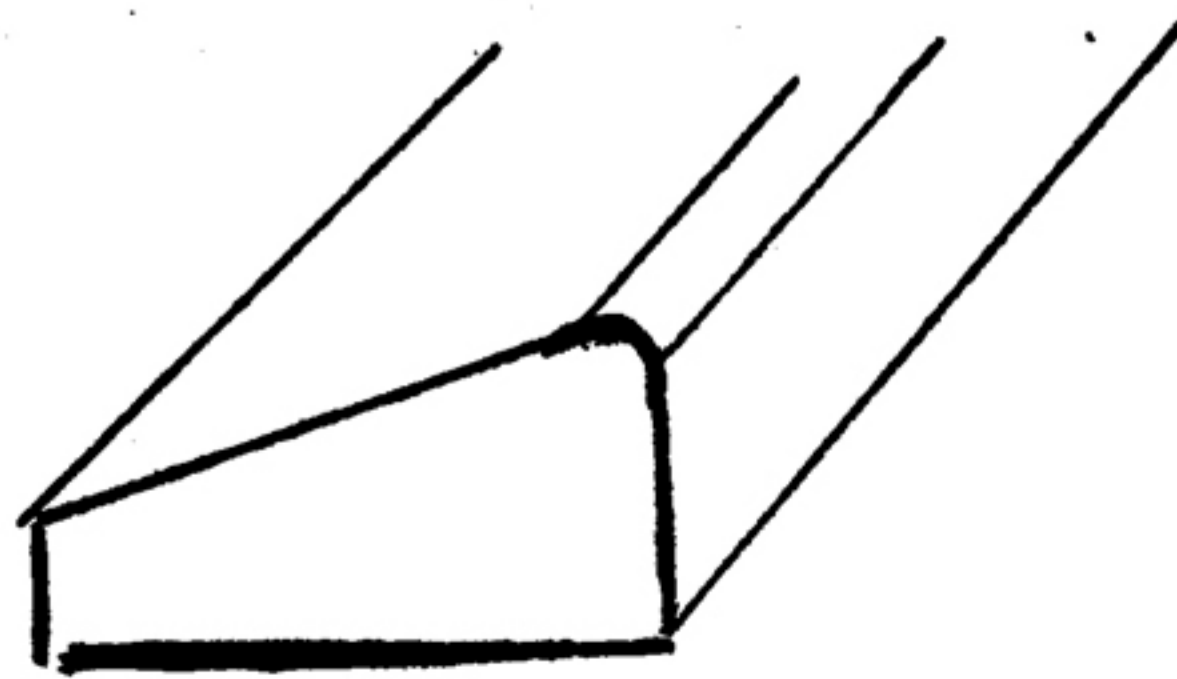

$\frac{1}{4}$